

For Lease

Eastern Canyon Plaza

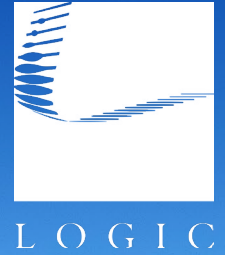

Lease Rate Reduction

8515 S. Eastern Ave.
Las Vegas, NV 89123

Jason Otter
Founding Partner
702.954.4109
jotter@logicCRE.com
S.0168161.LLC

Cooper Powell
Senior Associate
702.954.4154
cpowell@logicCRE.com
BS.0145955.LLC

Bart DeBuono
Senior Associate
702.954.4129
bdebuono@logicCRE.com
S.0176508.LLC

Elena Otter
Client Relations Representative
702.604.3388
eotter@logicCRE.com

Listing Snapshot



\$3.00 PSF NNN
~~\$3.25 PSF NNN~~
Lease Rate



± 1,248 SF
Available Square Footage

Property Highlights

- ± 1,248 SF of **restaurant space available**, Suite 103
- Current tenants include Village Pub, Check City, and Fuzzy Dice
- Located in a medical/retail hub with many healthcare and retail tenants
- Situated on the prominent corner of Wigwam and Eastern Avenues in a mature suburban area
- Exceptional visibility and high traffic counts of ± 47,300 CPD
- Convenient access to the CC-215 freeway with traffic counts of ± 176,000 CPD
- Surrounded by strong demographics with over 346,936 residents in the area
- **Do not disturb tenant**

Demographics

	1-mile	3-mile	5-mile
2025 Population	17,535	157,539	346,936
2025 Average Household Income	\$112,484	\$121,694	\$120,047
2025 Total Households	7,321	65,130	141,944



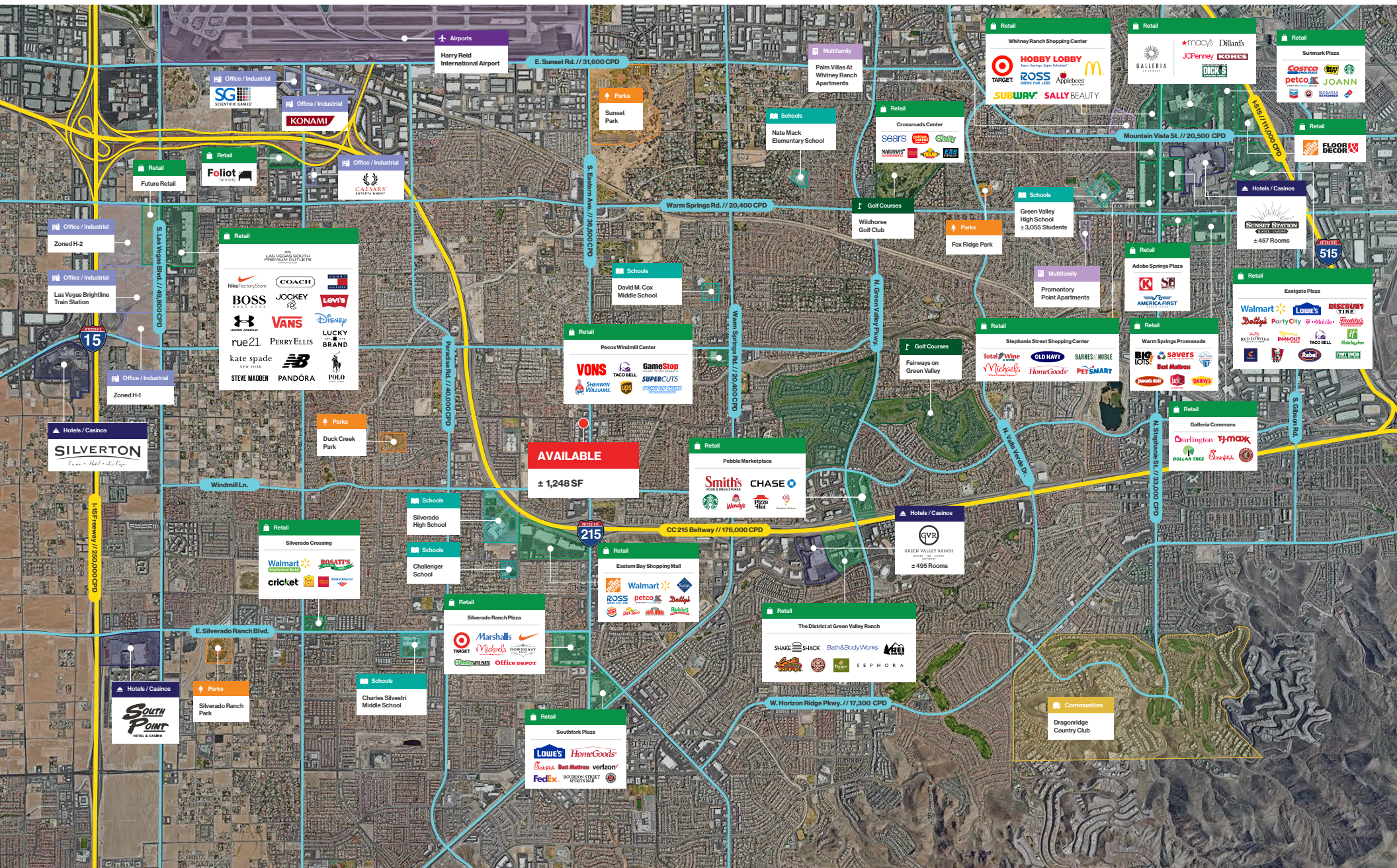

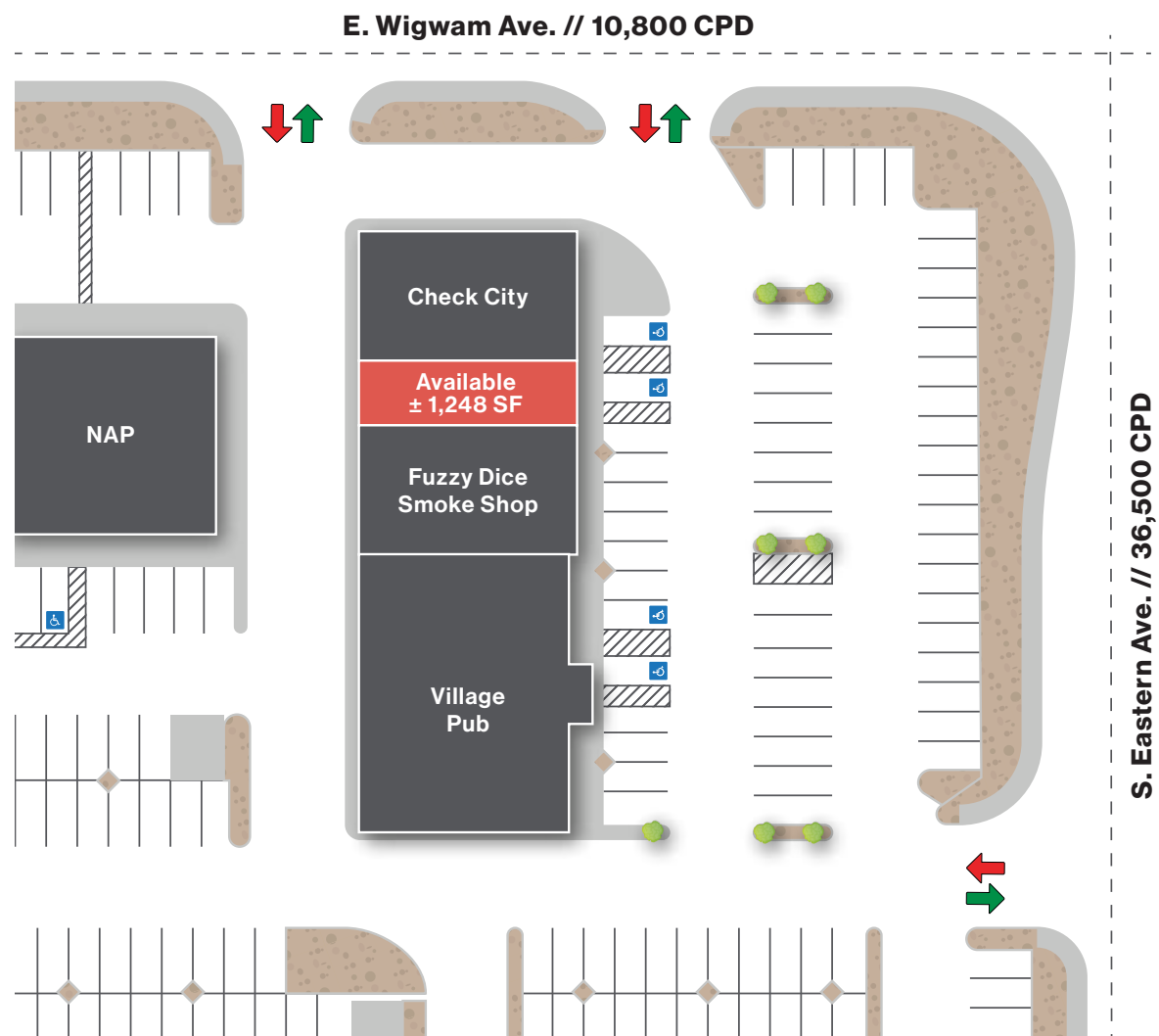

Floor Plan | Suite 103 | ± 1,248 SF

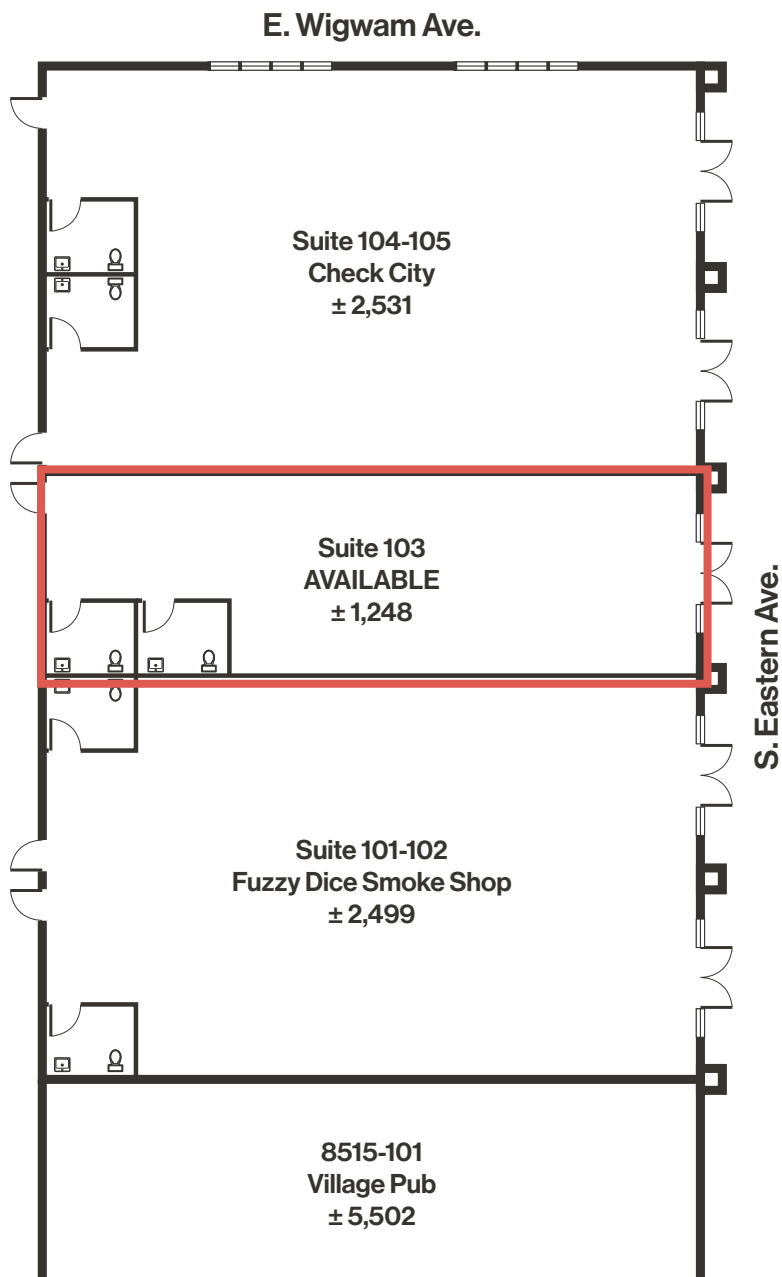

Suite	Tenant	SF
8515-101	Village Pub	± 5,502 SF
101-102	Fuzzy Dice, LLC	± 2,499 SF
103	AVAILABLE	± 1,248 SF
104-105	Check City, LLC	± 2,531 SF



LOGIC Commercial Real Estate

Specializing in Brokerage and Receivership Services



Join our email list and
connect with us on LinkedIn

The information herein was obtained from sources deemed reliable; however LOGIC Commercial Real Estate makes no guarantees, warranties or representation as to the completeness or accuracy thereof.

For inquiries please
reach out to our team.

Jason Otter

Founding Partner
702.954.4109
jotter@logicCRE.com
S.0168161.LLC

Cooper Powell

Senior Associate
702.954.4154
cpowell@logicCRE.com
BS.0145955.LLC

Bart DeBuono

Senior Associate
702.954.4129
bdebuono@logicCRE.com
S.0176508.LLC

Elena Otter

Client Relations Representative
702.604.3388
eotter@logicCRE.com